

WESTBOROUGH PUBLIC LIBRARY

Space Plan Presentation

February 2014

A LITTLE HISTORY



- The Westborough Public Library began in 1777 as a lending library that was located in the Parkman Store.
- 1807: Union Library Society formed.
- 1857: Ownership of the library transferred to the town.
- 1868: Moved to Town Hall. The library stayed in the old Parkman Store until 1868, when it was moved to the Town Hall.
- 1908: Land purchased, building constructed & opened.
- 1980: Building expanded.



SPACE CHALLENGES

- Shifts in the way people use the space
- Furniture/fixtures old and worn
- Space is not flexible
- Insufficient meeting space
- Some structure-related issues



TECHNOLOGY INFRASTRUCTURE

- Power & data infrastructure are insufficient for a 21st century library.
- Over a century's worth of wiring/cables inside the walls.



FUTURE PROJECTIONS

- Overall, undersized for future population
- Staffing level below national standards
- Circulation on an upward trend over 10 years.

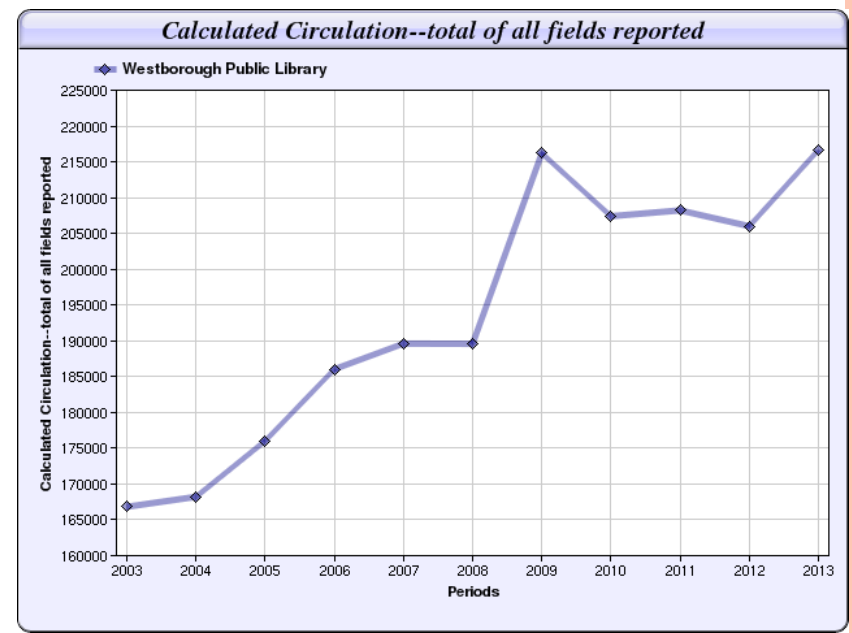
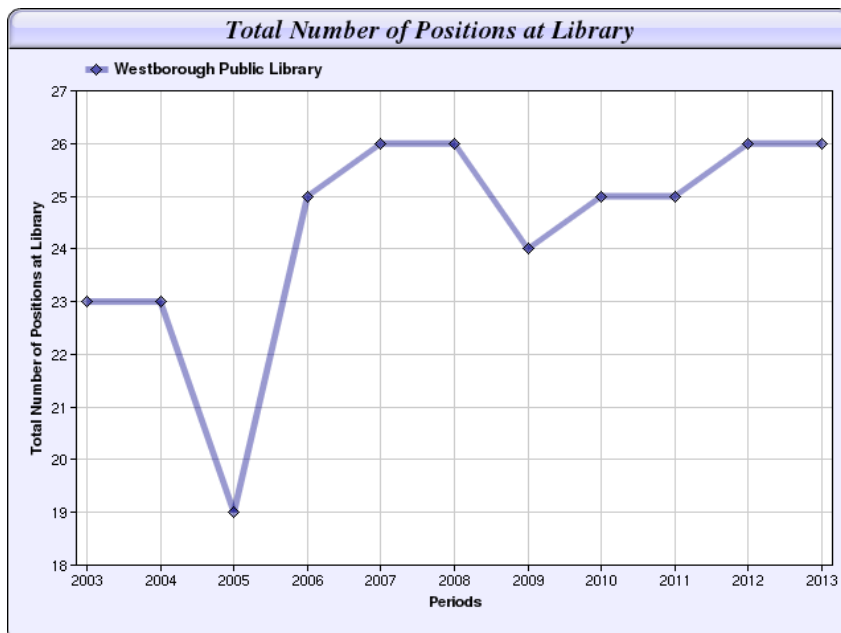

CONCLUSIONS

- Staffing & technology are at 2003 levels
- Insufficient parking, study space, computers
- Long range plan goals



POSSIBLE SOLUTIONS

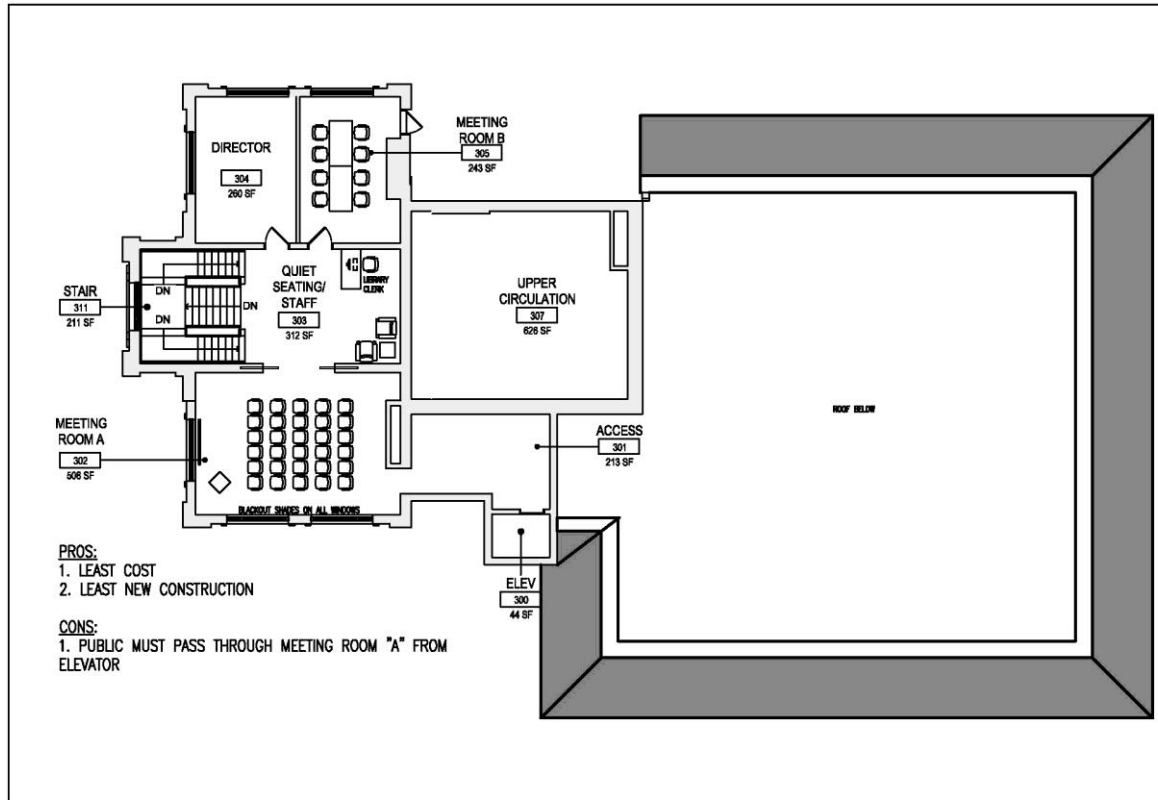

WESTBOROUGH PUBLIC LIBRARY
08-22-12

OPTION "E"

PROPOSED UPPER LEVEL FLOOR PLAN
SCALE: 1/16" = 1'-0"

3



LOWER LEVEL

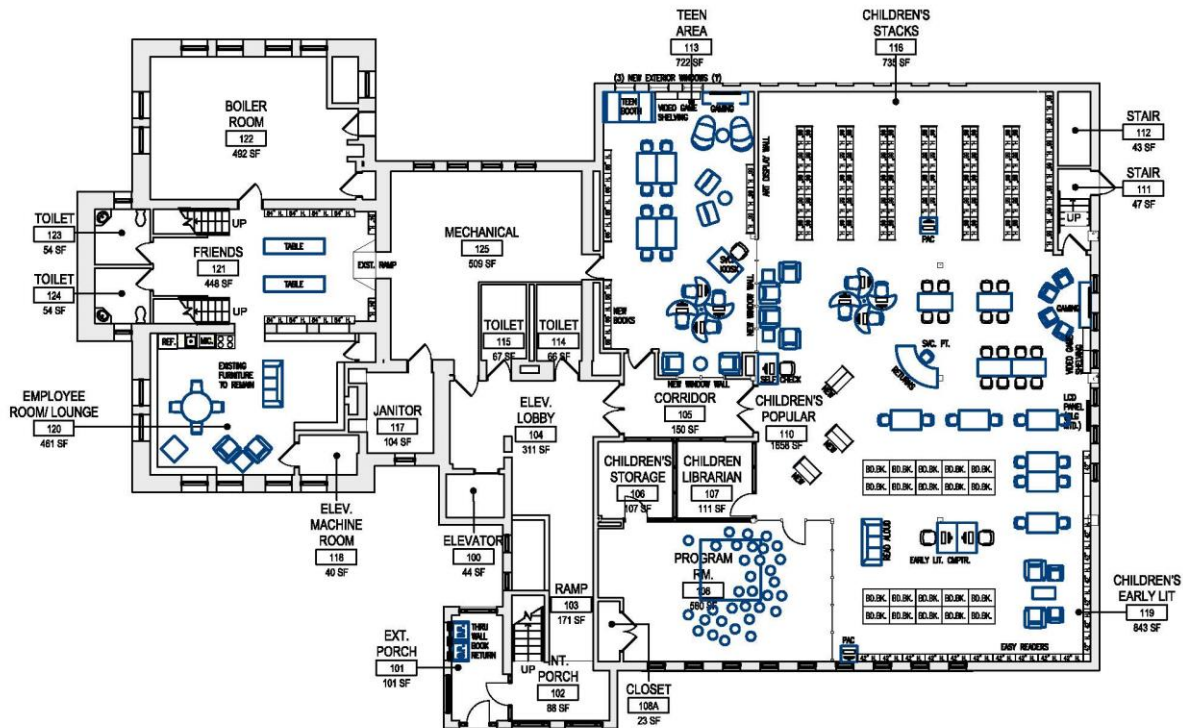

WESTBOROUGH PUBLIC LIBRARY
08-22-12

PROPOSED LOWER LEVEL FLOOR PLAN
SCALE: 1/16" = 1'-0"

1



FUNDING THE IMPROVEMENTS

- Planning and Design grant (July 2014)
- Construction grant round expected in FY2015
- First projects would begin around FY2017
- Excluded items
- Staffing improvements

